

Secure Wireless Network Access

How to configure your iOS device to access the "SU-Secure" wireless network

This guide will walk you through setting up your iOS device in order to connect to the "SU-Secure" wireless network at Salisbury University.

Step 1

Click Settings.

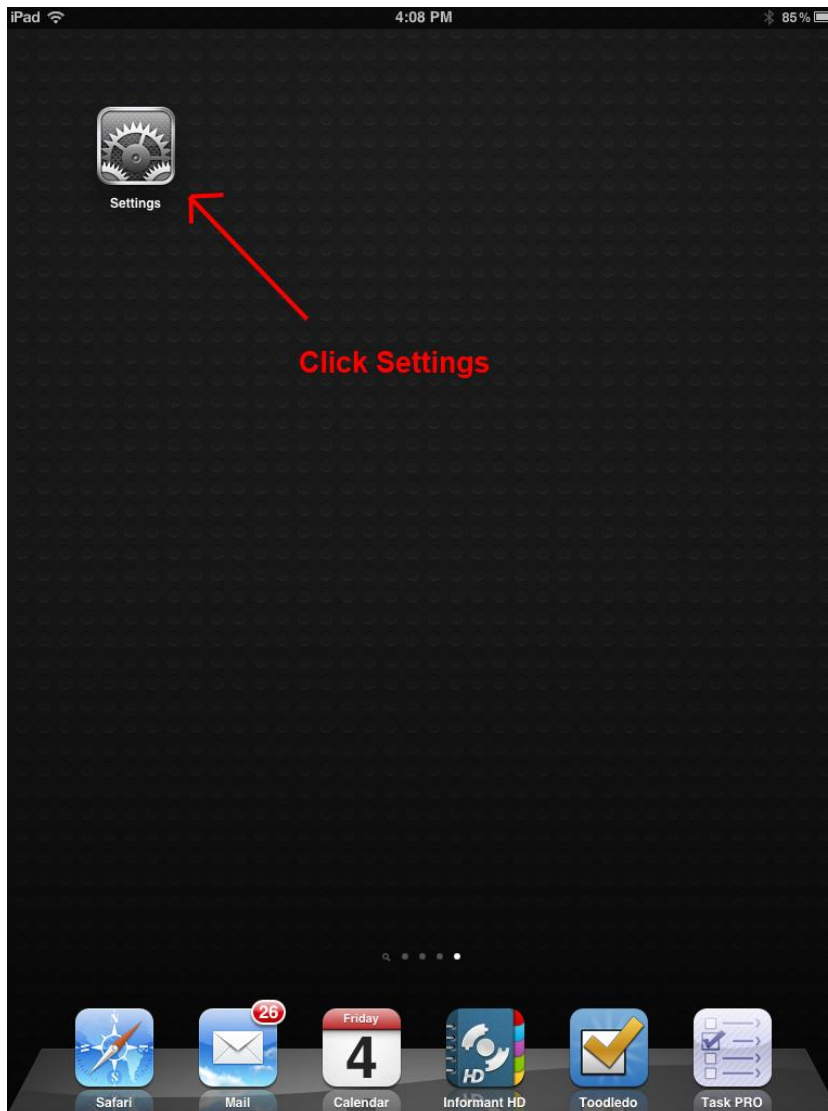

Step 2

Select and turn on Wi-Fi. Click SU-Secure.



Step 3

Enter your SU username and password.

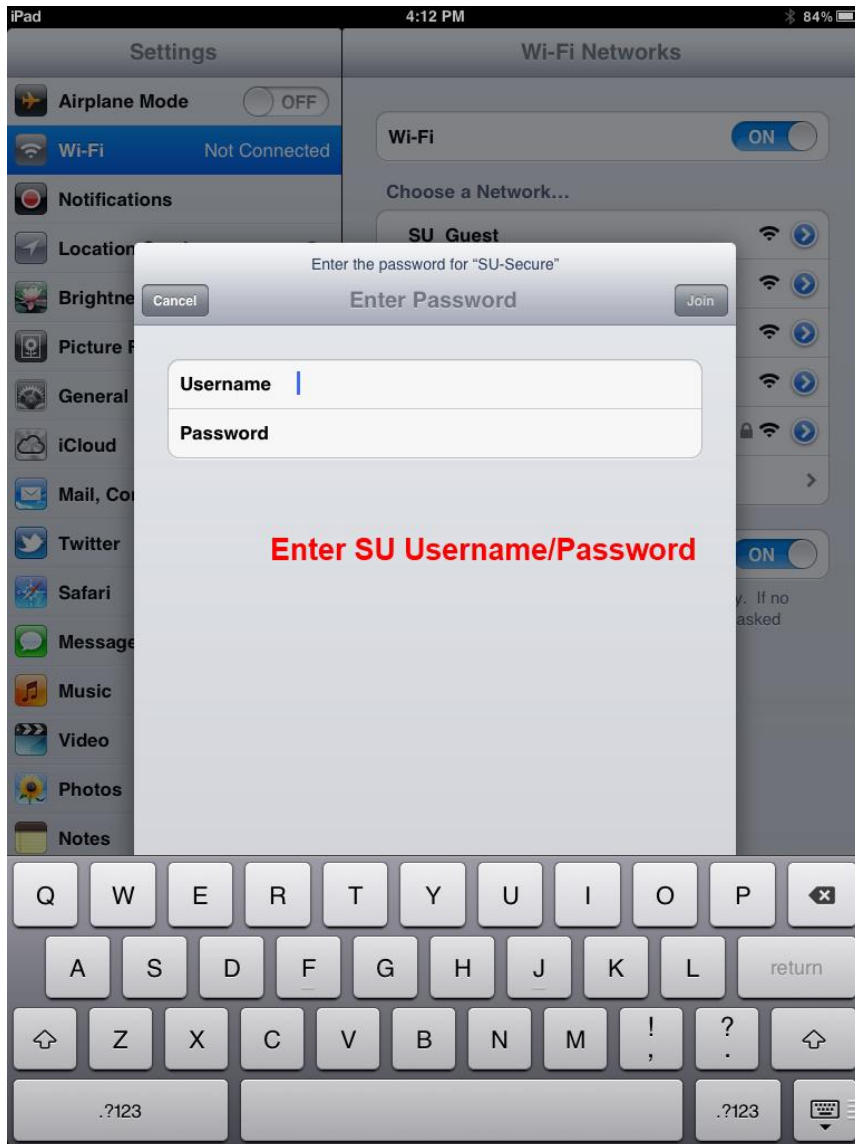

Step 4

Accept the certificate from Salisbury.edu. You should now be connected to SU-Secure!

