

(Excludes parking lots)

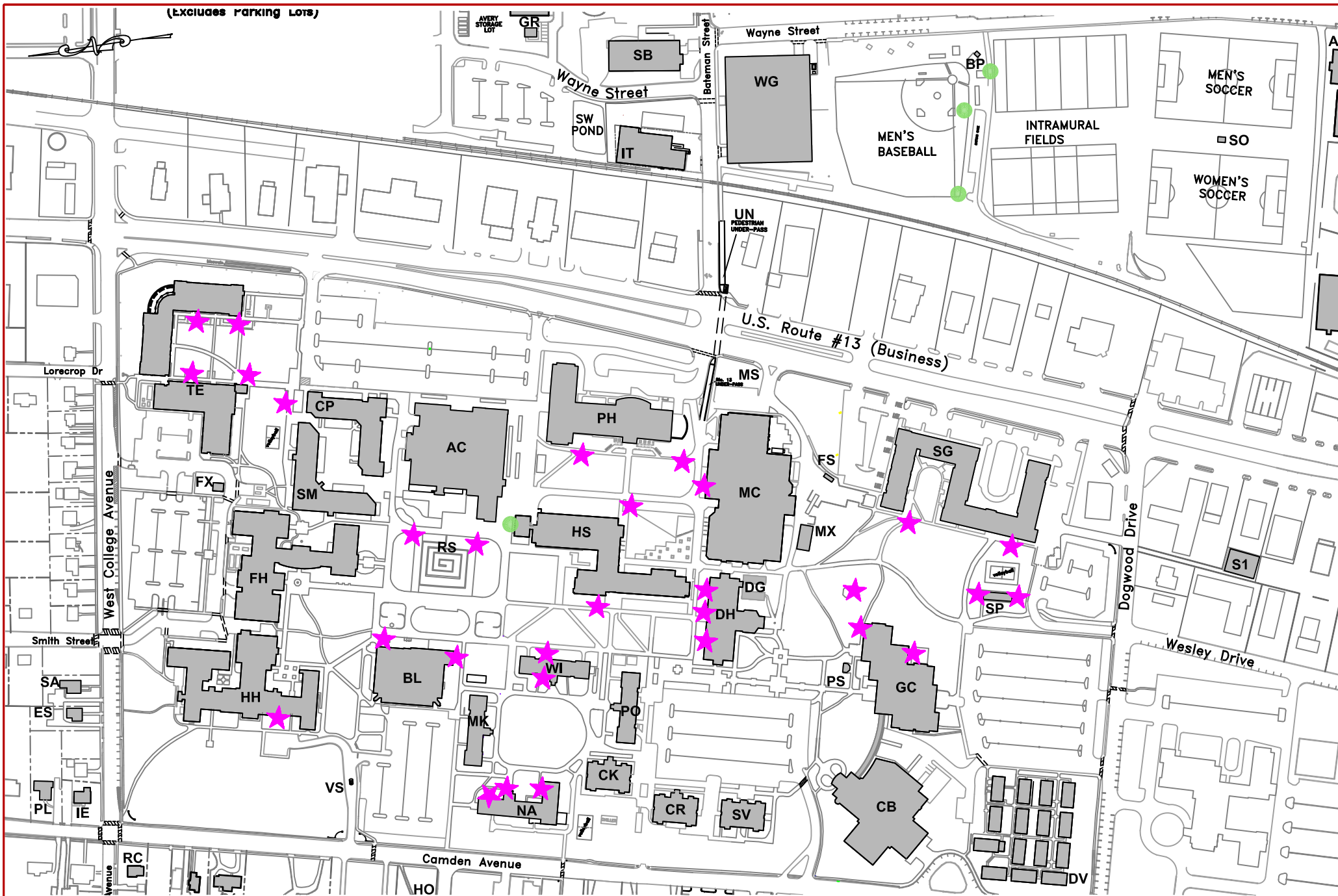

SALISBURY UNIVERSITY
 FACILITIES PLANNING & CAPITAL PROJECTS
 ARCHITECTURAL AND ENGINEERING SERVICES
 1101 CAMDEN AVENUE
 SALISBURY, MARYLAND 21801
 410 - 543 - 6215

DETAIL 5.1-P
CAMPUS ELECTRICAL
120 volt EXTERIOR SOURCES

★ = 120 volt Electrical Source (Exterior)

● = 120 volt Electrical Source (Exterior) Require Work Order to access and use

DATE
 03/24/17
 SCALE: NTS
 DRAWING NAME:
 U-5.1-P